

SPECIAL EVENT & ACTIVITY PERMIT APPLICATION ATTACHMENT G

RULES AND REGULATIONS FOR PARK SPECIAL EVENTS

PARK RENTAL NUMBER: _____

Violations of the below regulations can result in the loss of your deposit:

- Set up is park rental time as stated on the reservation sheet
- No driving on the lawn
- Vehicles can not be left in event area unless they are part of the display
- No glass containers on park property
- No stakes or spikes driven into park property
- All decorations must be removed by the event and its vendors
- No driving in event area during event hours
- No parking in the loading zone area – unload and move the vehicle
- No parking or blocking the sidewalk
- Vendors must dispose of grease according to Washoe County Health Department regulations
- If event is at City Plaza, no driving on the ice rink pad
- No damage to turf area or irrigation system
- Bounce house must provide its own portable generator
- Bounce houses must be set up on non-turf/non-plant areas
- Dunk tanks must have prior approval, removal of water must follow the regulations of the Washoe County District Health Department
- No dogs allowed during special events unless special permission has been granted (e.g., Paws in the Park – animals are the event)

MAPS OF SPECIAL EVENT PARKS

Site Plans

Maps of Wingfield Park, West Wingfield Park, City Plaza, McKinley, and Idlewild (3) are on the following pages. Please select the park that you are holding your event in and use the map provided to fill in your site layout.



WINGFIELD PARK

Scale 1" = 50'

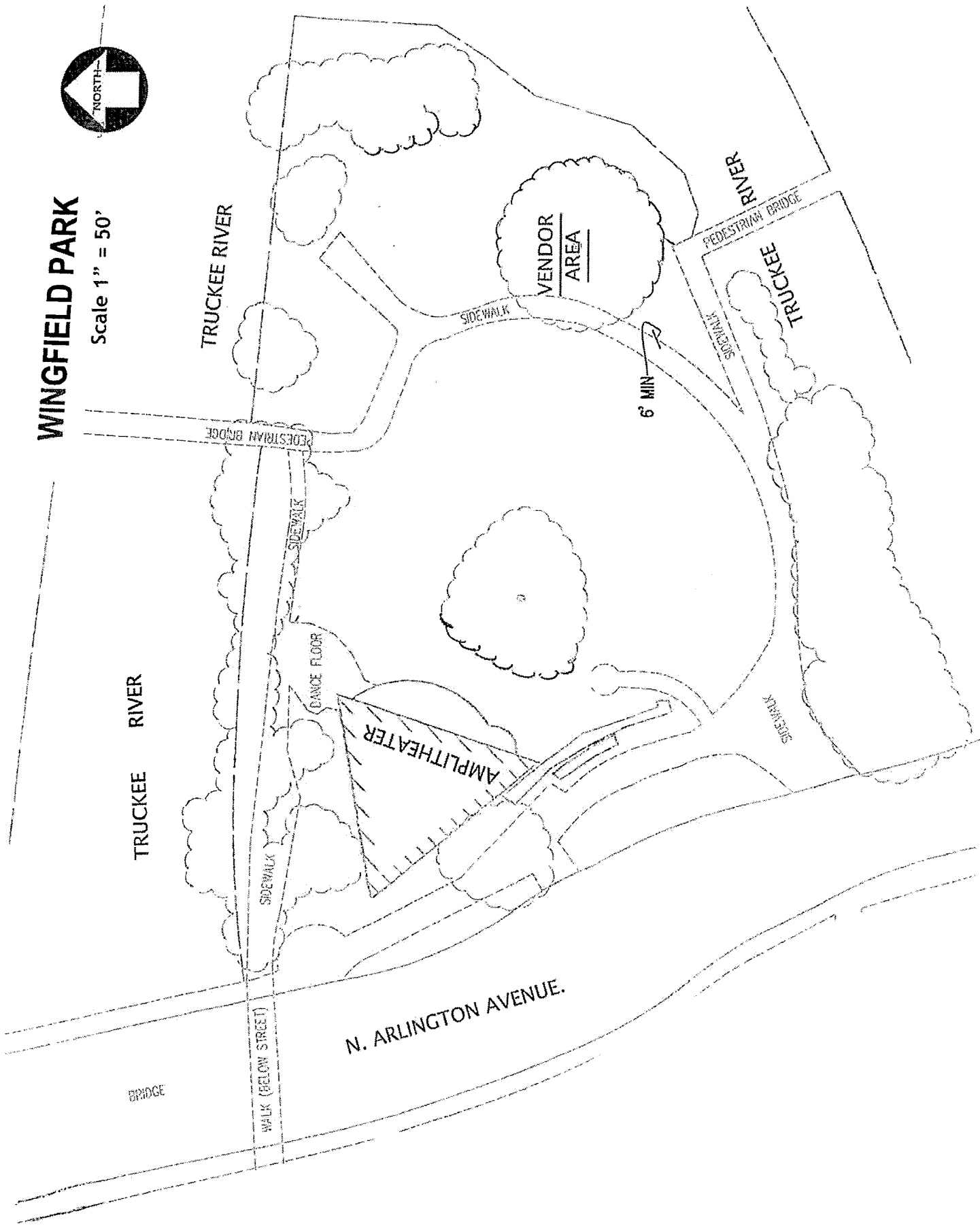

N. ARLINGTON AVENUE.

LEGEND

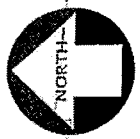

-  ELECTRIC
-  LIGHT POLE W/ ELECTRIC

TRUCKEE RIVER

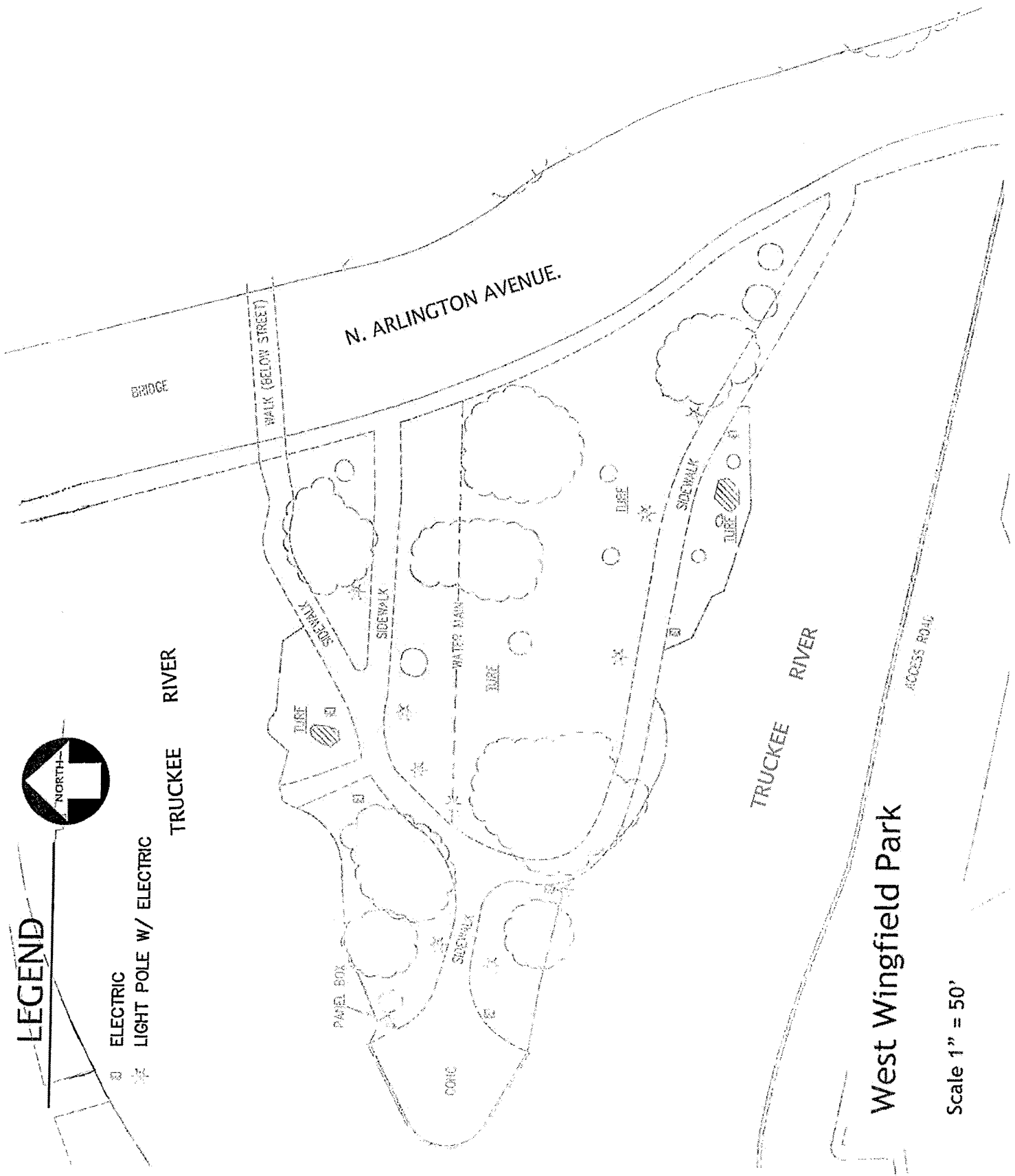

West Wingfield Park

Scale 1" = 50'

- 500' around footprint of ice rink
- 4 light poles around rink
- 10 light poles on river with outlets
- 5 lights on Virginia St
- 6 garbage cans

CITY PLAZA

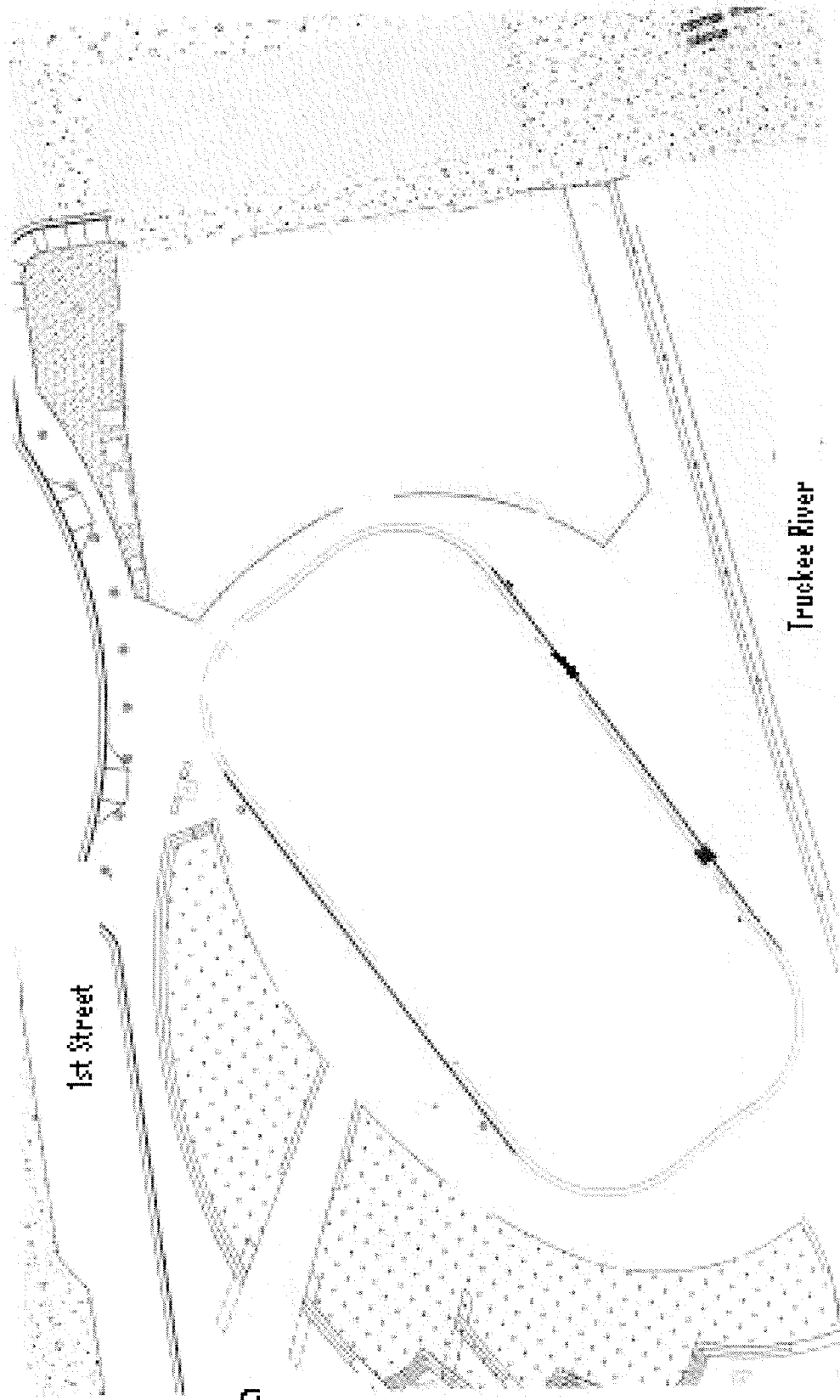

Virginia St

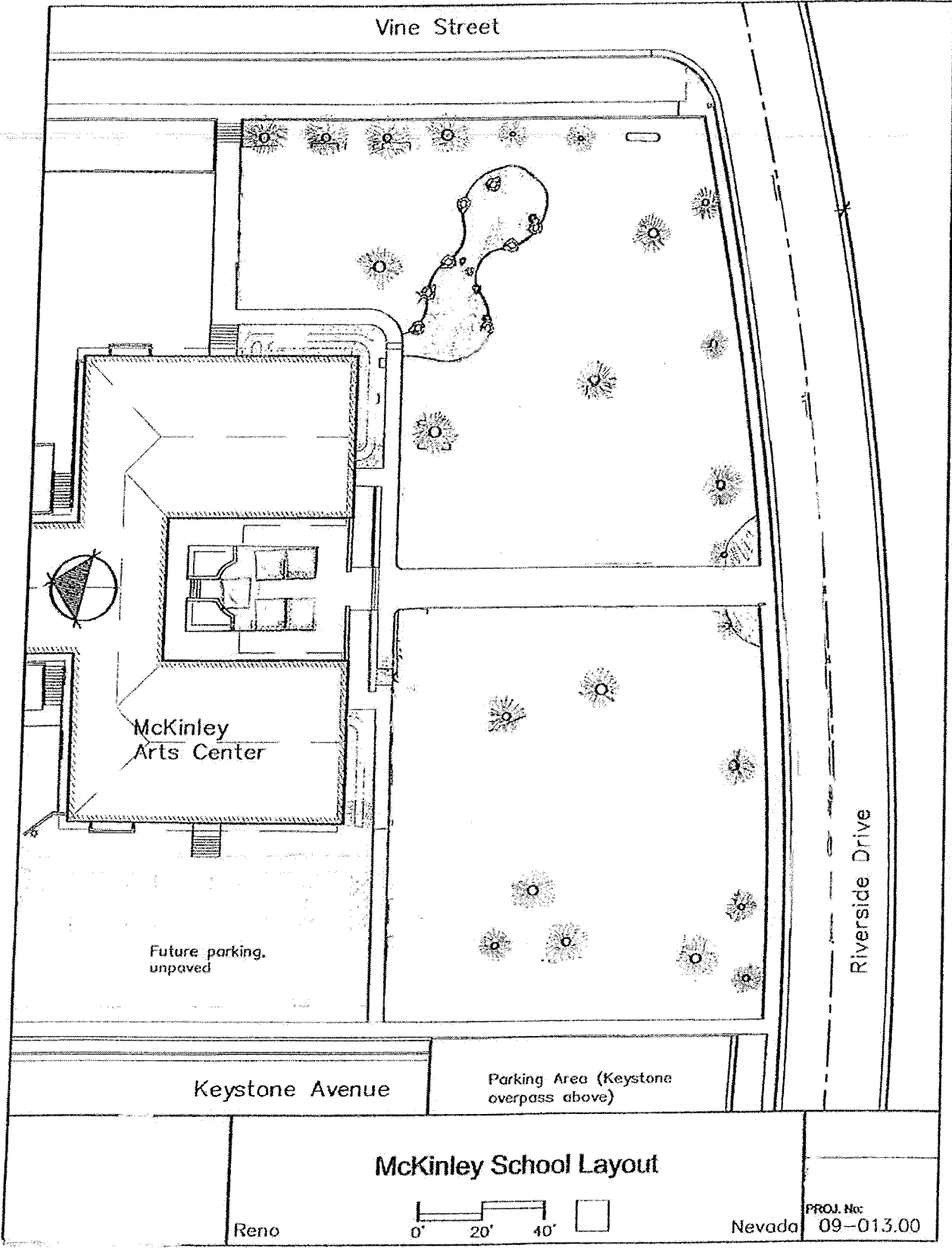

Vine Street

McKinley
Arts Center

Future parking,
unpaved

Keystone Avenue

Parking Area (Keystone
overpass above)

Riverside Drive

McKinley School Layout

Reno

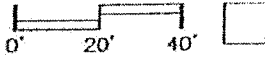

Nevada

PROJ. No:
09-013.00

IDEWILD PARK

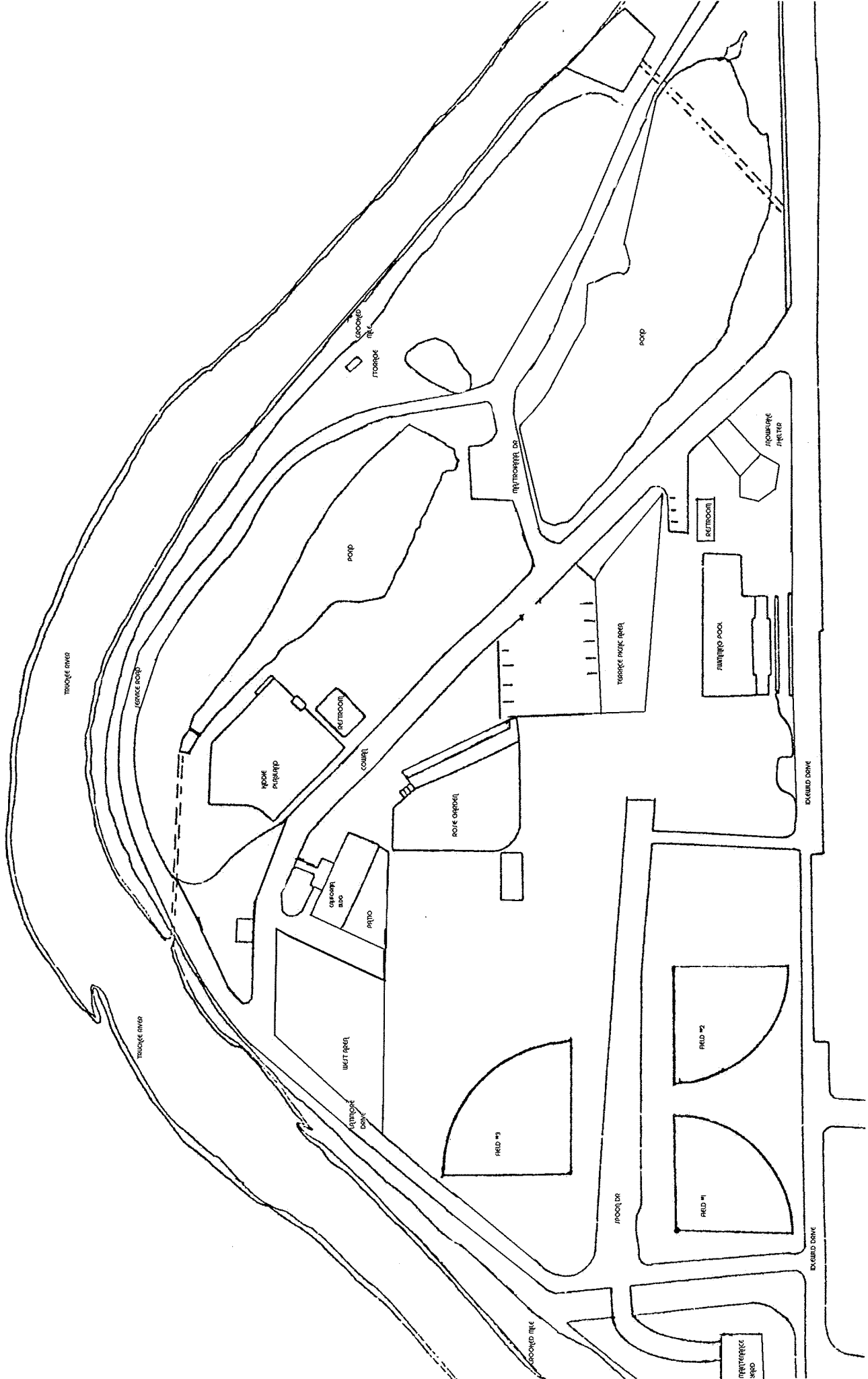

Ball field

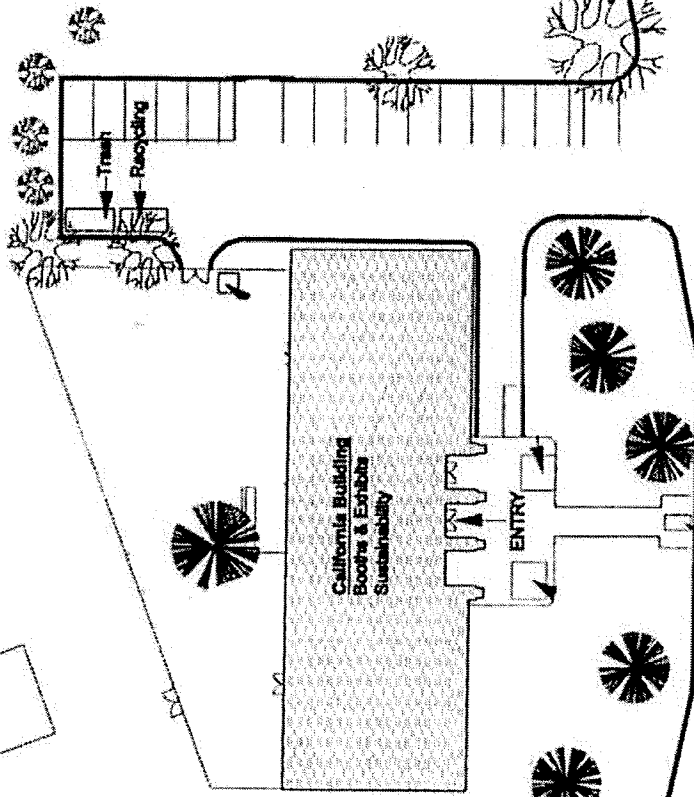
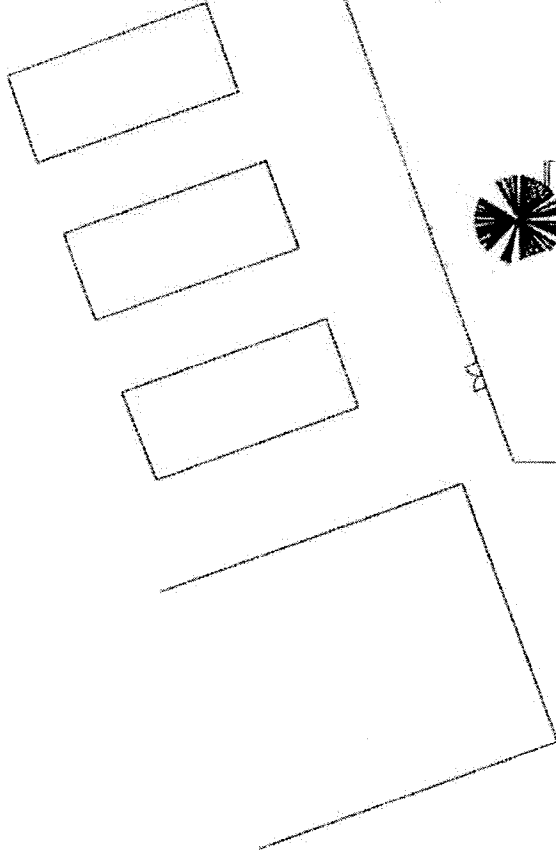

Cowan Dr

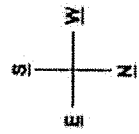

Idlewild Park
California Bldg
& lawn

Idlewild "Bowl"

↑ NORTH

SCALE 1 : 602

